



COAXIAL

Precision Fixed Attenuator **BW-S50W2+**

50Ω 2 W 50 dB DC to 18 GHz SMA-Female to SMA-Male

FEATURES

- DC to 18 GHz
- Precision Attenuation
- Excellent VSWR, 1.20 Typ.
- Stainless Steel SMA Male and Female Connectors



Generic photo used for illustration purposes only

APPLICATIONS

- Impedance Matching
- Instrumentation
- Test Setups

Model No.	BW-S50W2+
Case Style	FF659
Connectors	SMA-Female to SMA-Male

+RoHS Compliant
 The +Suffix identifies RoHS Compliance.
 See our website for methodologies and qualifications

ELECTRICAL SPECIFICATIONS AT +25°C

Parameter	Frequency (GHz)	Min.	Typ.	Max.	Unit
Frequency Range		DC		18	GHz
Attenuation, Nominal			50		dB
Attenuation, Accuracy ¹	DC - 18		±1.5		dB
VSWR ²	DC - 4			1.15	:1
	4 - 8			1.20	
	8 - 12.4			1.25	
Input Power ³				2.0	W

1. At +25°C, accuracy includes frequency and power variations. Temperature coefficient for attenuation: .0004 dB/dB/°C typ.
 2. Average power at +25°C ambient, derate linearly to 0.875 W at +100°C. Peak Power 250 W max. 5 μsec. pulse width, 100 Hz PRF.

ABSOLUTE MAXIMUM RATINGS

Parameter	Ratings
Operating Temperature	-55°C to +100°C
Storage Temperature ⁴	-55°C to +100°C

4. With mated connectors. Unmated, +85°C max.
 Permanent damage may occur if any of these limits are exceeded.

ELECTRICAL SCHEMATIC

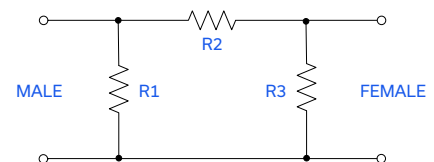

REV. C
 ECO-024322
 BW-S50W2+
 MCL NY
 250127





COAXIAL

Precision Fixed Attenuator **BW-S50W2+**

50Ω 2 W 50 dB DC to 18 GHz SMA-Female to SMA-Male

OUTLINE DRAWING

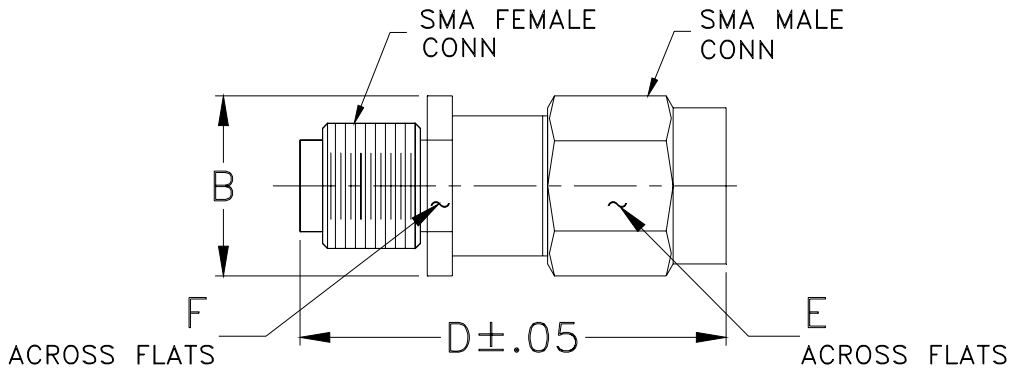

OUTLINE DIMENSIONS (Inch/mm)

B	D	E	F	wt
.36	.99	.312	.312	grams
9.14	25.15	7.92	7.92	5.1



COAXIAL

Precision Fixed Attenuator **BW-S50W2+**

50Ω 2 W 50 dB DC to 18 GHz SMA-Female to SMA-Male

TYPICAL PERFORMANCE DATA AND CHARTS

Frequency (MHz)	Attenuation (dB)	VSWR (:1)
200.00	49.64	1.00
600.00	49.85	1.00
1000.00	49.93	1.00
2000.00	49.88	1.00
3000.00	49.94	1.00
4000.00	49.96	1.01
5000.00	50.14	1.02
7000.00	50.26	1.02
9000.00	50.10	1.01
11000.00	50.25	1.04
13000.00	49.98	1.08
15000.00	50.34	1.11
16000.00	50.35	1.11
17000.00	50.12	1.11
18000.00	49.57	1.10

BW-S50W2+
ATTENUATION

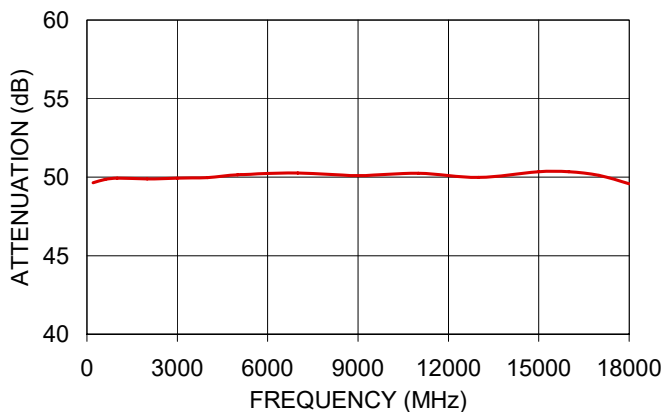

BW-S50W2+
VSWR

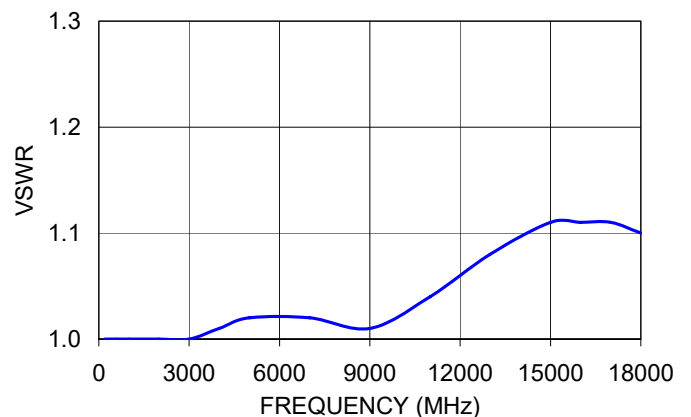

NOTES

- A. Performance and quality attributes and conditions not expressly stated in this specification document are intended to be excluded and do not form a part of this specification document.
- B. Electrical specifications and performance data contained in this specification document are based on Mini-Circuits' applicable established test performance criteria and measurement instructions.
- C. The parts covered by this specification document are subject to Mini-Circuits' standard limited warranty and terms and conditions (collectively, "Standard Terms"); Purchasers of this part are entitled to the rights and benefits contained therein. For a full statement of the standard terms and the exclusive rights and remedies thereunder, please visit Mini-Circuits' website at www.minicircuits.com/terms/viewterm.html



Mouser Electronics

Authorized Distributor

Click to View Pricing, Inventory, Delivery & Lifecycle Information:

[Mini-Circuits:](#)

[BW-S50W2+](#)