

MICRO SWITCH
a Honeywell Division

FED.MFG.CODE 91929

SWITCH ASSEMBLY

CATALOG LISTING

38HM20

CATALOG LISTING
PAGE 1 OF 1
RELEASE NO. PR-20776
REPLACES
38HM20
ISSUE
10
M
REVISIONS
A PR-20776 TSM 10 NOV 93
B CO-84436 LJK 15 MAR 97
C CO-94220 DLT 25 MAR 99
D 0000107 TSM 3 APR 03
E 0079652 SBH 22JUL11
CHECK
10 NOV 93
12 NOV 93
S A V
DRAWN
TSM

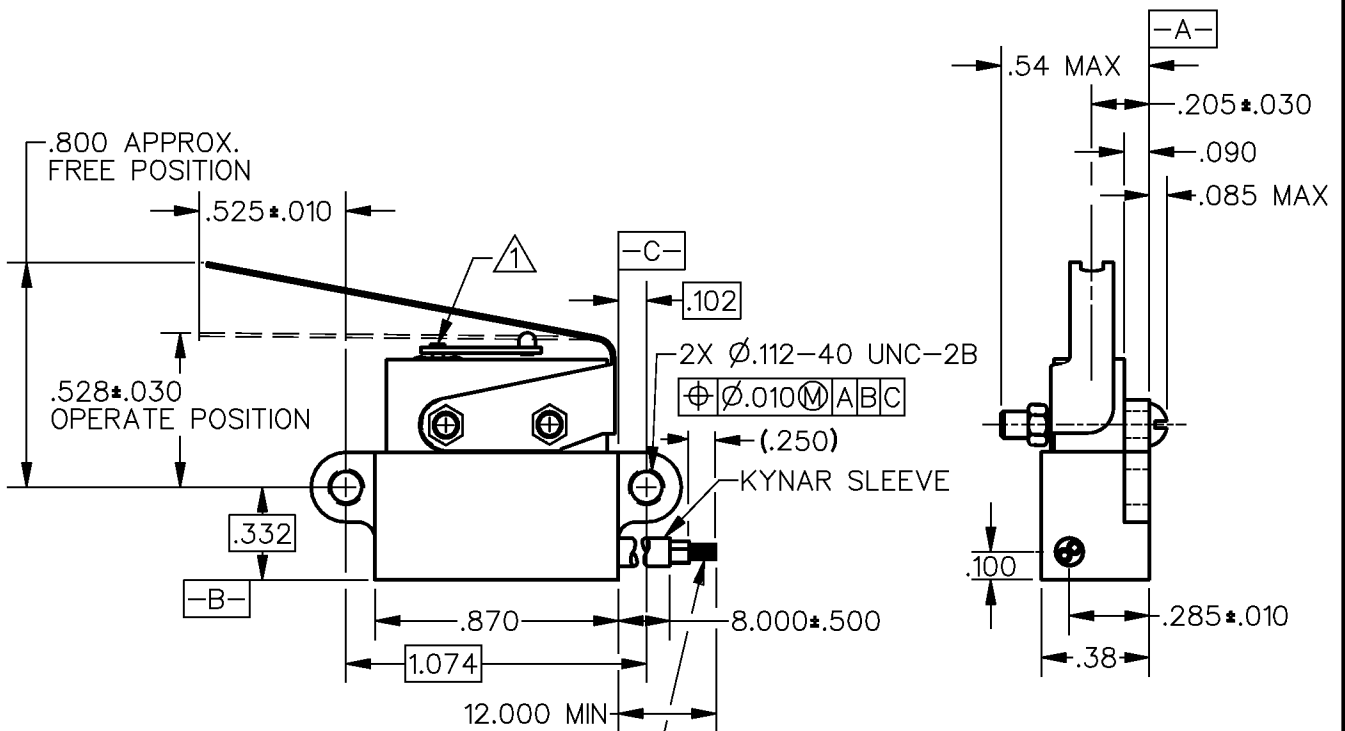

2X NO. 24 WIRE LEAD PER
MIL-W-22759/11 MARKED
WITH CIRCUIT IDENT AND
WIRE GAGE (C-24, NO-24)
PER MIL-W-5088

NOTES

- 1 - ADJUSTMENT CAUTION: DO NOT ALLOW ACTUATOR LEAF TO COME IN CONTACT WITH HM LEVER TO PREVENT SWITCH SEAL DAMAGE
- 2 - ASSEMBLY INCLUDES: "20HM" TYPE BASIC SWITCH AND JS TYPE ACTUATOR
- 3 - ALL EXPOSED PARTS ARE OF CORROSION RESISTANT MATERIALS
- 4 - GOLD ALLOY STATIONARY CONTACTS AND 24K GOLD MOVABLE CONTACT
- 5 - FOR USE IN TEMPERATURE RANGE -300°F TO +350°F

THIS DRAWING COVERS A PROPRIETARY ITEM AND IS THE PROPERTY OF MICRO SWITCH, A DIVISION OF HONEYWELL. THIS DRAWING IS NOT TO BE COPIED OR USED WITHOUT THE APPROVAL OF MICRO SWITCH.

THIRD ANGLE PROJECTION

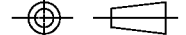

CHARACTERISTICS

OPERATING FORCE — — — — 6 OZ MAX
RELEASE FORCE — — — — 1 OZ MIN
DIFFERENTIAL TRAVEL — — .120 MAX
OVERTRAVEL — — — — .120 MIN

ELECTRICAL DATA

CONTACT ARRANGEMENT
S P N O

28 VOLTS DC RATING
INDUCTIVE — — — — SEA LEVEL — — 1/4 AMP
70,000 FT — — 1/4 AMP
RESISTIVE — — — — SEA LEVEL — — 1/2 AMP
70,000 FT — — 1/2 AMP

SCALE 1.5:1

DO NOT
SCALE PRINT

UNLESS OTHERWISE SPECIFIED
TOLERANCES ARE

ONE PLACE (.0) ± .030
TWO PLACE (.00) ± .015
THREE PLACE (.000) ± .005
ANGLES ±

WEIGHT .80 OZ MAX

Mouser Electronics

Authorized Distributor

Click to View Pricing, Inventory, Delivery & Lifecycle Information:

[Honeywell:](#)

[38HM20](#)