

PLUG HOUSING

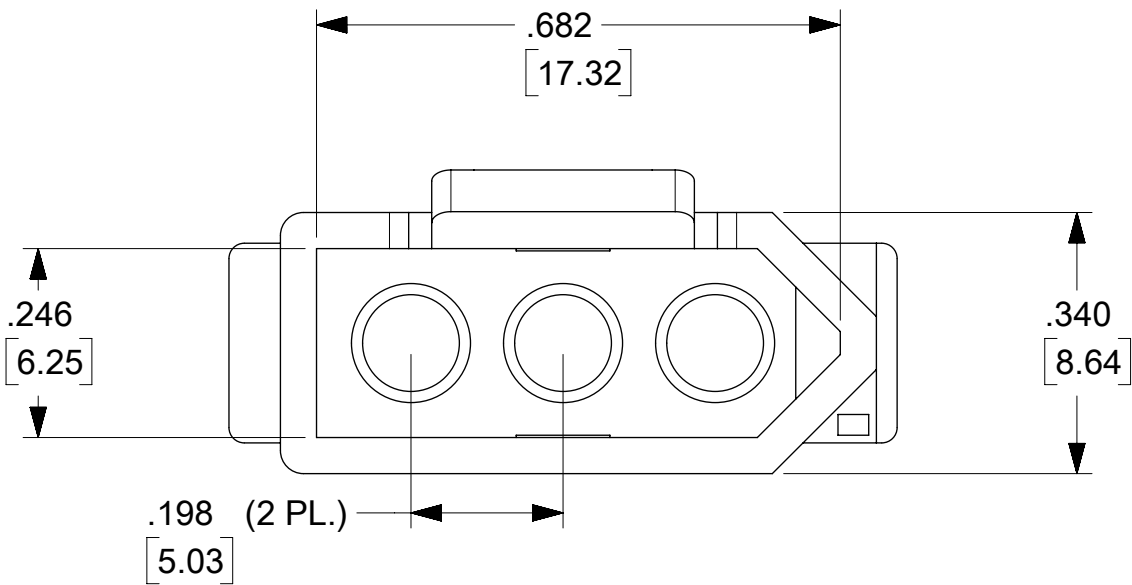

QUALITY SYMBOLS		THIS DRAWING CONTAINS INFORMATION THAT IS PROPRIETARY TO MOLEX ELECTRONIC TECHNOLOGIES, LLC AND SHOULD NOT BE USED WITHOUT WRITTEN PERMISSION													
	= 0	ADD PK SPEC EC NO: 108502 DRWN: BAPPELDORN CHKD: MKIPPER APPR: FSMITH	2016/09/06 2016/09/20 2016/09/23	GENERAL TOLERANCES (UNLESS SPECIFIED)			DIMENSION UNITS		SCALE		<div>molex®</div>				
	= 0				MM	INCH	IN/MM		4:1						
	= 0			4 PLACES	±	±	DRWN BY		DATE		<div>.093/(2.36) HOUSING PLUG AND RECEPTACLE 3 CIRCUIT</div>				
	= 0			3 PLACES	±	± .010	AELHAG		12/17/2008						
	= 0			2 PLACES	± 0.25	± .014	CHK'D BY		DATE						
	= 0			1 PLACES	± 0.36	±	JBELL		12/17/2008						
	= 0			0 PLACES	±	±	APPR BY		DATE		PRODUCT CUSTOMER DRAWING				
	= 0			ANGULAR TOL ± 1/2			FSMITH		2014/12/18						
	= 0			DRAFT WHERE APPLICABLE MUST REMAIN WITHIN DIMENSIONS			DRAWING SIZE		THIRD ANGLE PROJECTION		SERIES	MATERIAL NUMBER		CUSTOMER	
	= 0						C				42191	SEE CHART		GENERAL MARKET	
		A		REV		DOCUMENT NUMBER				DOC TYPE	DOC PART	SHEET NUMBER			
						421910300-SD				PSD	000	1 OF 3			

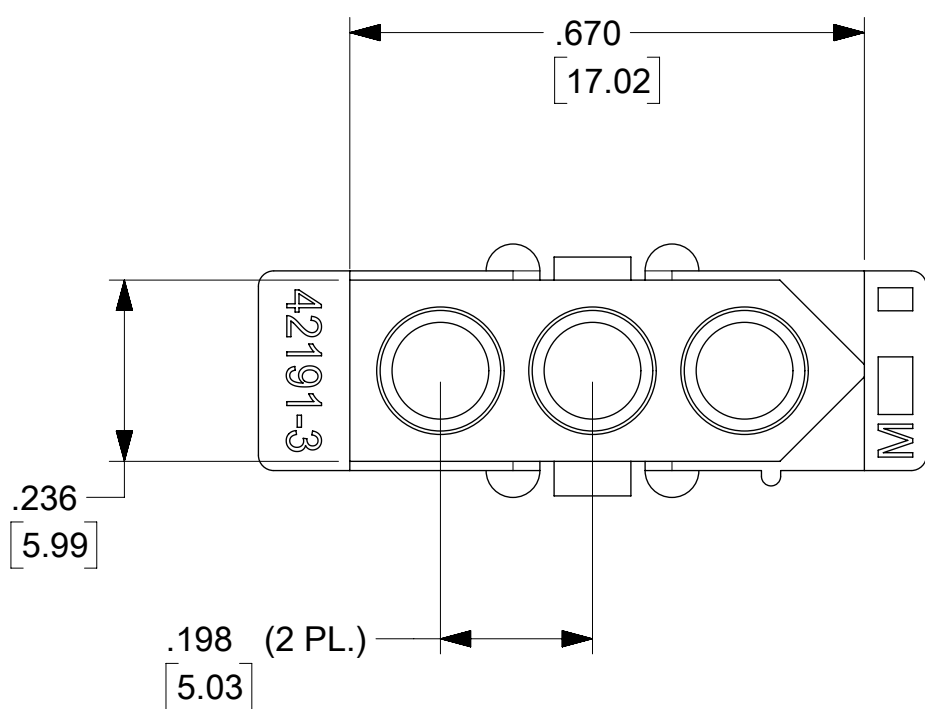

RELEASE STATUS	P1	RELEASE DATE	23.09.2016	15:44:38
----------------	----	--------------	------------	----------

Mouser Electronics

Authorized Distributor

Click to View Pricing, Inventory, Delivery & Lifecycle Information:

Molex:

03-09-1171