

REVISIONS					
REV	ECO	DESCRIPTION	BY	DATE	APP'D
1	21374	ORIGINAL RELEASE	TD	07-28-09	DATE
2	21388	DATAPLATE CHANGE	TD	08-10-09	DE

UNCONTROLLED DOCUMENT
WILL NOT BE UPDATED

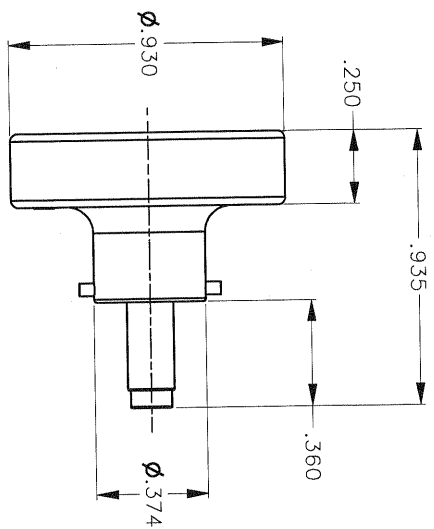

LOCATOR	
HOLE DIMENSIONS	ADDITIONAL FEATURES
$\phi .045$	
$\nabla .476$	

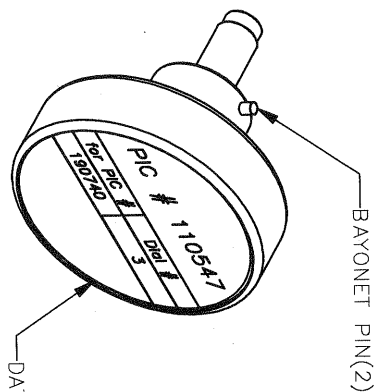
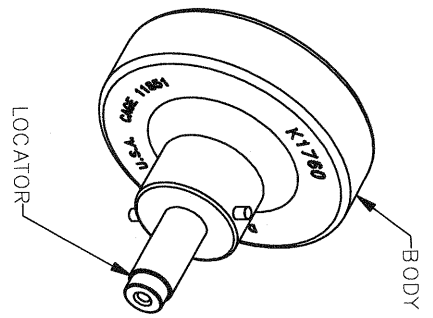

PIC # 110547	
for PIC #	Dial #
190740	3

RESTRICTED & CONFIDENTIAL CONFIDENTIAL PROPERTY OF DANIELS MANUFACTURING CORP. NOT TO BE DISCLOSED TO OTHERS, REPRODUCED OR USED FOR ANY OTHER PURPOSE EXCEPT AS AUTHORIZED IN WRITING BY DANIELS MANUFACTURING CORP. ON COMPLETION OF ORDER OR OTHER PURPOSE FOR WHICH SENT.		MATERIAL		FINISH	
		ITEM	PART NO.	QTY.	DESCRIPTION/REMARKS
		DES. <i>George Dilworth</i> DATE 07-28-09 CHK'D.	APP'D. DATE DATE	NOTE: THIS DRAWING IS AN OUTLINE DRAWING OF THE RESPECTIVE INDICATED ACTUAL DIM. PART NUMBER WITHOUT THE "-ENV" SUFFIX.	
		HEAT TREAT		WHERE USED: CAD P/N K1760-ENV SHEET 1 OF 1 POSTIONER ENVELOPE DRAWING	
DO NOT SCALE DRAWING		PMC DANIELS MANUFACTURING CORP. ORLANDO, FLORIDA CAGE 11851			

NOTE: FOR USE WITH DANIELS CRIMP TOOLS
ACCOMMODATING "K" SERIES POSITIONERS

Mouser Electronics

Authorized Distributor

Click to View Pricing, Inventory, Delivery & Lifecycle Information:

[Daniels Manufacturing:](#)

[K1760](#)